

Pallet Feet & Fittings

SQUARE



1410

Thickness: **2.3**
 Weight (Kg/100): **25**
 Post size(mm): **40**
 Load testing average
 per ft (Tonne): **2.46**

PALLET FOOT 89MM SQUARE X
 2.3 mm THICK

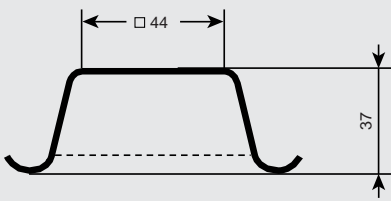

0138

Thickness: **2.3**
 Weight (Kg/100): **25**
 Post size(mm): **50**
 Load testing average
 per ft (Tonne): **2.19**

PALLET FOOT 127MM SQUARE X
 2.3 mm THICK

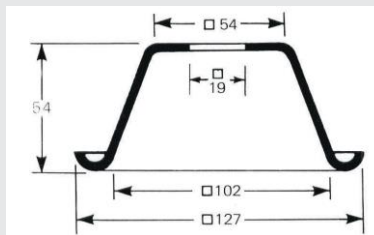

0100

Thickness: **3**
 Weight (Kg/100): **50**
 Post size(mm): **50**
 Load testing average
 per ft (Tonne): **4.36**

PALLET FOOT 127MM SQUARE X
 3.0 mm THICK

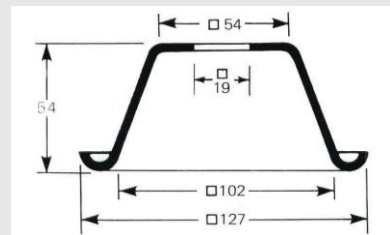

0104

Thickness: **3.2**
 Weight (Kg/100): **60**
 Post size(mm): **50**
 Load testing average
 per ft (Tonne): **4.78**

PALLET FOOT 127 SQ X 3.2MM
 THICK

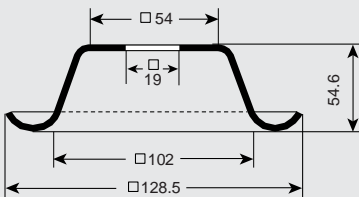

0139

Thickness: **2.3**
 Weight (Kg/100): **60**
 Post size(mm): **60**
 Load testing average
 per ft (Tonne): **6.29**

PALLET FOOT 127 SQ X 2.3 mm
 THICK- 64MM TOP

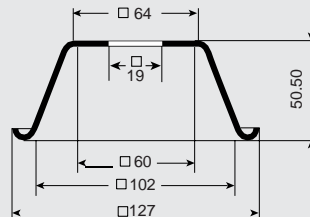

0101

Thickness: **3.0**
 Weight (Kg/100): **60**
 Post size(mm): **60**
 Load testing average
 per ft (Tonne): **8.27**

PALLET FOOT 127 SQ X 3.0 mm
 THICK- 64MM TOP

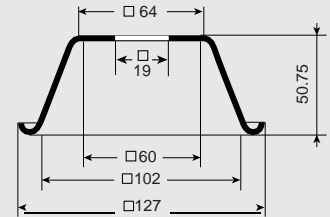

All measurements in mm

Bakjam Steel Fabrications

T+971 4 3400 901 E: info@bakjam.com W: www.bakjamfabrications.com
 Al Quoz industrial area # 4, Dubai, UAE

Pallet Feet & Fittings

SQUARE

0143

Thickness:
Weight
Post size(mm): **60**

PALLET FOOT 127 SQ X 3.2MM
THICK-66MM TOP

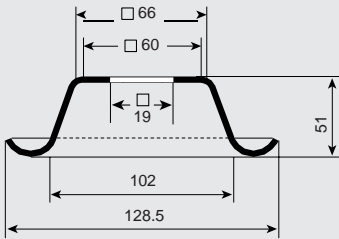

0140

Thickness: **3.0**
Weight (Kg/100): **98**
Post size(mm): **70**
Load testing average
per ft (Tonne): **4.58**

PALLET FOOT 165MM SQUARE X
3.0 mm THICK

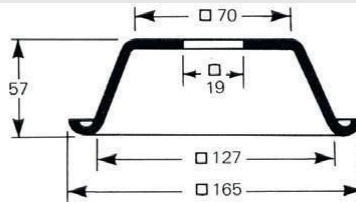

0140S

Thickness:
Weight (Kg)
Post size(mm): **70**

PALLET FOOT 165 SQ X 3.0MM -
STAINLESS STEEL

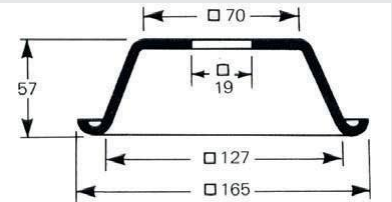

0142

Thickness:
Weight (Kg/100): **68**
Post size(mm): **50**
Load testing average
per ft (Tonne): **7.28**

TOYOTA PALLET FOOT (F66)
100MM SQUARE

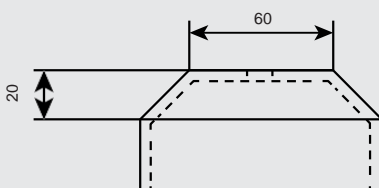

0141

Thickness:
Weight (Kg)
Post size(mm): **50**

TOYOTA TOP CAP FOR 50MM SQ
RHS

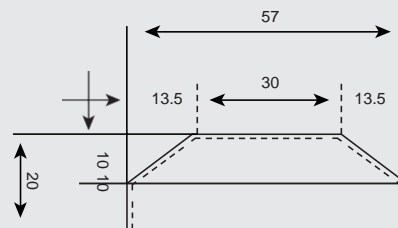

0102

Thickness: **6**
Weight (Kg/100): **150**
Post size(mm): **60**
Load testing average
per ft (Tonne): **18.25**

PALLET FOOT 130MM SQUARE X
6.0 mm THICK

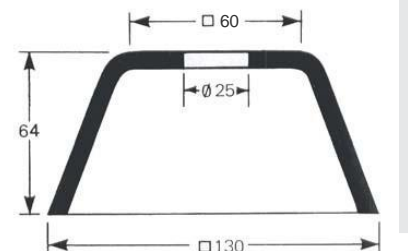

All measurements in mm

Bakjam Steel Fabrications

T+971 4 3400 901 E: info@bakjam.com W: www.bakjamfabrications.com
Al Quoz industrial area # 4, Dubai, UAE

Pallet Feet & Fittings **SQUARE**

0105

Thickness: **5.0**

Weight (Kg/100): **125**

Post size(mm): **80**

Load testing average
per ft (Tonne): **15.99**

PALLET FOOT 152MM SQUARE X
5.0 mm THICK

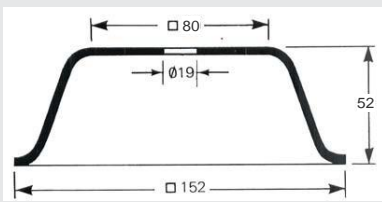

All measurements in mm

Pallet Feet & Fittings ROUND

0107

Thickness: 3.0
Weight (Kg/100): 49
Post size(mm): 70



ROUND PALLET FOOT 130mm DIA
X 3.0 mm THICK

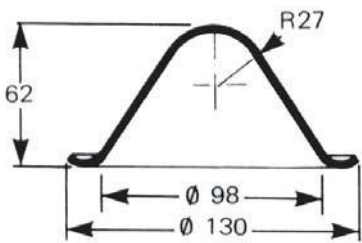

0118

Thickness: 3.0
Weight (Kg/100): 41
Post size(mm): 70



ROUND PALLET FOOT 130mm DIA
X 3.0 mm THICK

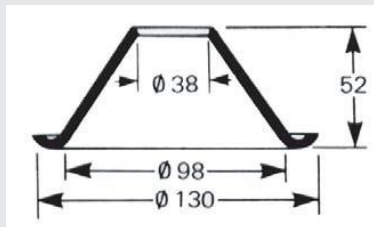

0113

Thickness: 3.0
Weight (Kg/100): 60
Post size(mm): 60



ROUND PALLET FOOT 97mm DIA
X 3.0 mm THICK

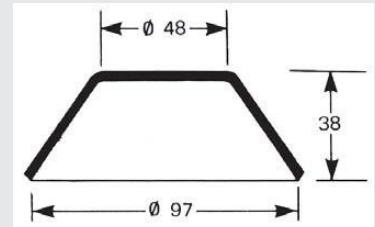

0113S

Thickness: 3.0
Weight (Kg/100):
Post size(mm): 60



ROUND PALLET FOOT 97 DIA X
3.0mm THICK 55 - STAINLESS
STEEL

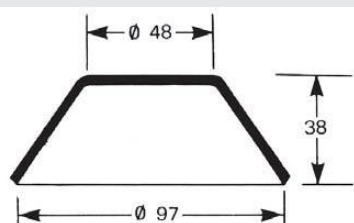

0114

Thickness: 1.6
Weight (Kg/100): 25
Post size(mm): 25



ROUND PALLET FOOT 64MM DIA
X 1.6MM THICK

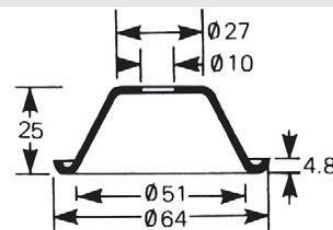

0124

Thickness: 3
Weight (Kg/100): 31
Post size(mm): 60



ROUND PALLET FOOT 129mm DIA
X 3.0 mm THICK

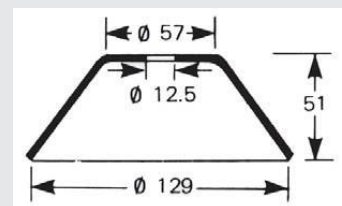

All measurements in mm

Bakjam Steel Fabrications

T+971 4 3400 901 E: info@bakjam.com W: www.bakjamfabrications.com
Al Quoz industrial area # 4, Dubai, UAE

Pallet Feet & Fittings

ROUND

0131

Thickness: **1.6**
 Weight (Kg/100): **6**
 Post size(mm): **70**



ROUND PALLET FOOT 64mm DIA
 X 1.6 mm THICK

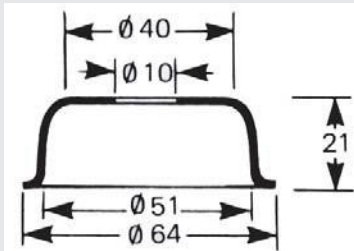

0125

Thickness: **3.0**
 Weight (Kg/100): **31**
 Post size(mm): **60**



ROUND PALLET FOOT 103mm DIA
 X 3.0 mm THICK S.S.

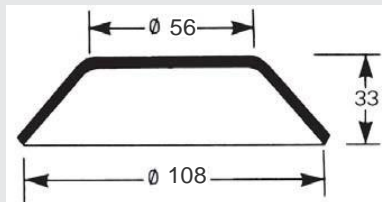

0125S

Thickness: **3.0**
 Weight (Kg/100): **31**
 Post size(mm): **60**



ROUND PALLET FOOT 103mm
 DIA X 3.0 mm THICK - STAINLESS
 STEEL

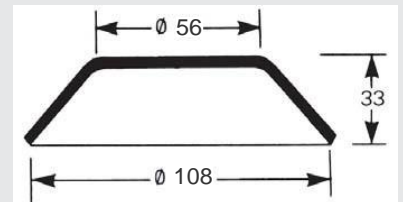

0145

Thickness: **2.5**
 Weight (Kg/10)
 Post size(mm): **60**



PATT 0145 - 60mm FLAT - 2.5mm
 PALLET FOOT - 110mm BASE

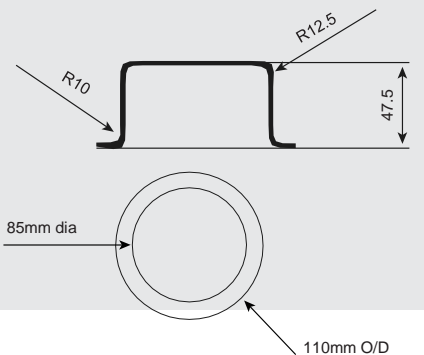

All measurements in mm

Bakjam Steel Fabrications

T+971 4 3400 901 E: info@bakjam.com W: www.bakjamfabrications.com
 Al Quoz industrial area # 4, Dubai, UAE



Pallet Feet & Fittings
NESTING PLUGS

0116
Thickne
Weight
Post size



THREE SIDED NESTING PLUG
50MM x 54MM

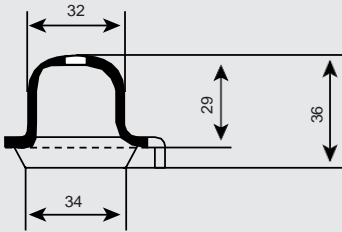

0117
Thickness: 3
Weight (Kg
Post size(mm): 50



FOUR SIDED NESTING PLUG
50MM SQ

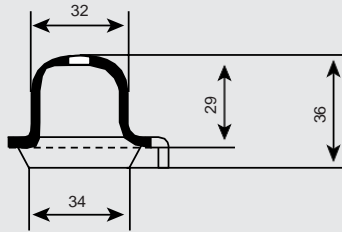

All measurements in mm

Bakjam Steel Fabrications

T+971 4 3400 901 E: info@bakjam.com W: www.bakjamfabrications.com
Al Quoz industrial area # 4, Dubai, UAE

Pallet Feet & Fittings

TWO SIDED PALLET FEET

0110

Thickness: 3
Weight (Kg/100): 16
Post size(mm): 40

TWO SIDED PALLET FOOT 70mm -
3mm THICK

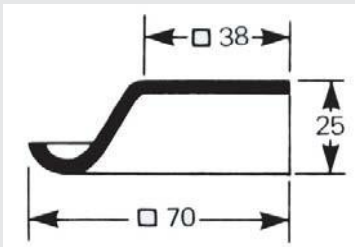

1546

Thickness: 5.0
Weight (Kg/100): 36

TWO SIDED PALLET FOOT 82mm -
4.8mm THICK

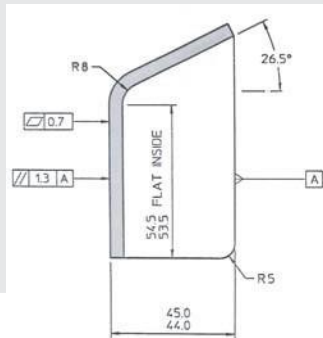

BS22

Thickness: 5.0
Weight (Kg/100): 45
Post size(mm): 70

PALLET FOOT TWO SIDED 90mm
5.00mm MS

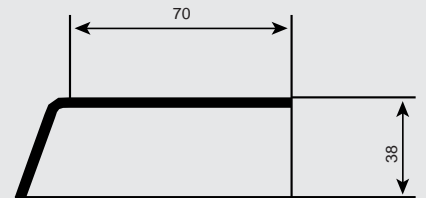

BS60

Thickness: 4.0
Weight (Kg/100): 62
Post size(mm): 50

PALLET FOOT TWO SIDED 108MM
4.00MM MS

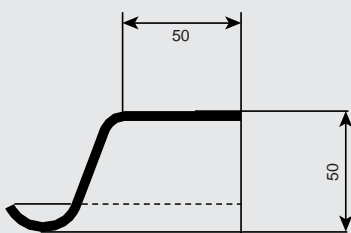

BS72

Thickness: 4.0
Post size(mm): 60

PALLET FOOT TWO SIDED 108MM
4.00MM MS

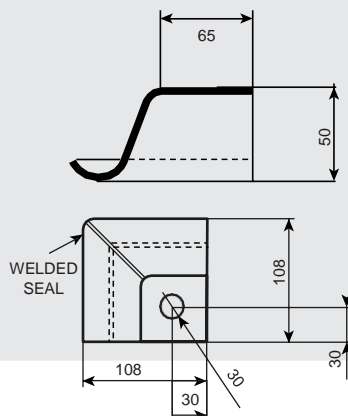

All measurements in mm

Bakjam Steel Fabrications

T+971 4 3400 901 E: info@bakjam.com W: www.bakjamfabrications.com

Al Quoz industrial area # 4, Dubai, UAE



Pallet Feet & Fittings
**PALLET FURNITURE/
 FITTINGS**

111(A)
 Thickness: 4.5
 Weight (Kg/100): 16

111(B)
 Thickness: 4.5
 Weight (Kg/100): 11

111(C)
 Thickness: 4.5
 Weight (Kg/100): 10

111(D)
 Thickness: 4.5
 Weight (Kg/100): 8

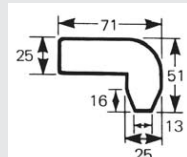
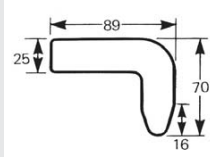
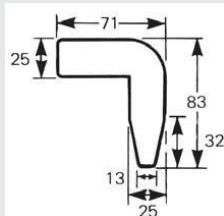
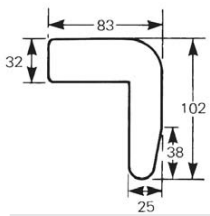

0112
 Thickness: 3.0
 Weight (Kg/100): 4
 Staple

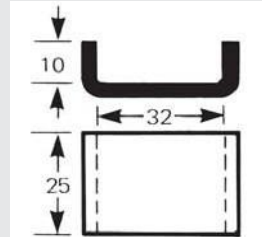

B2
 Thickness: 3.0
 Weight (Kg/100): 10
 Staple

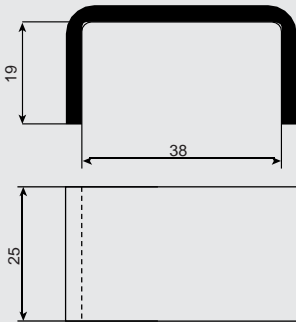

B11
 Thickness: 3.0
 Weight (Kg/100): 10
 Staple

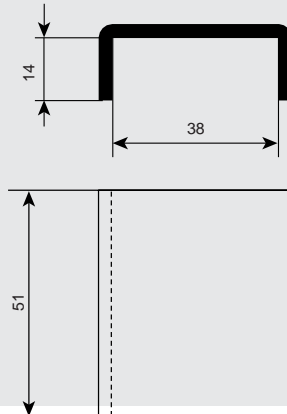

B5
 Thickness: 3
 Weight (Kg/100): 10
 Staple

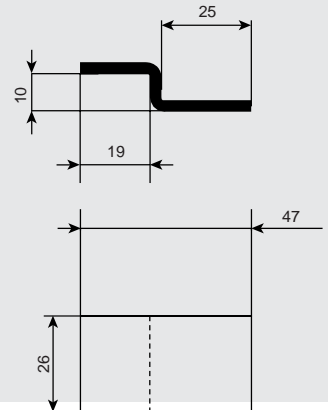

All measurements in mm

Bakjam Steel Fabrications

T+971 4 3400 901 E: info@bakjam.com W: www.bakjamfabrications.com
 Al Quoz industrial area # 4, Dubai, UAE

0549

Thickness: **1.6**

Weight (Kg/100): **6**

POST CAP 51.6MM - 1.6MM
THICK

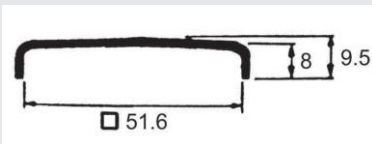
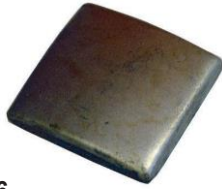

0141

Thickness: **3.0**

Weight (Kg/100):

Post size(mm): **50**

TOYOTA TOP CAP FOR 50MM SQ
RHS

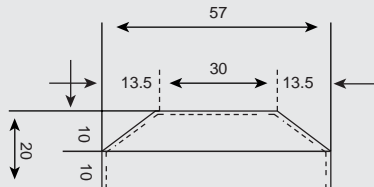

Pallet Feet & Fittings

SPRING & SHOOT BOLTS

0839/001

BASE RETAINING
ZINC PLATED

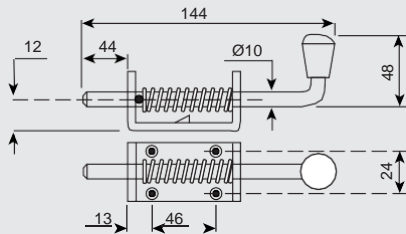

0840/001

BASE RETAINING
ZINC PLATED

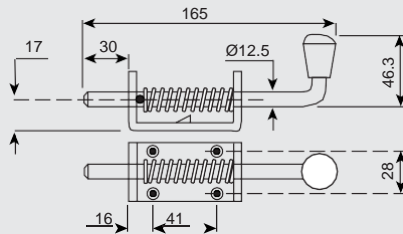

0840/002

BASE RETAINING
ZINC PLATED

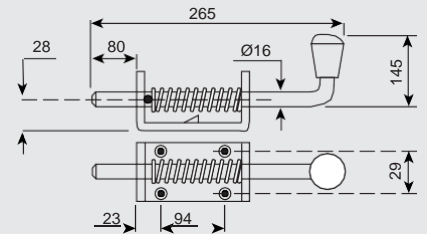

0841/001

BASE RETAINING
ZINC PLATED

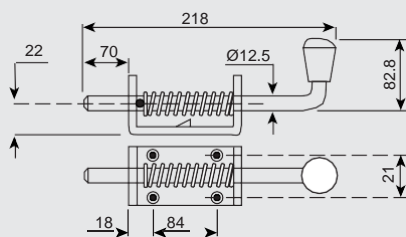

0836/001

BASE RETAINING WITH BASE TO
WELD ON.
ZINC PLATED BALL WITH A SELF
COLOUR BRACKET

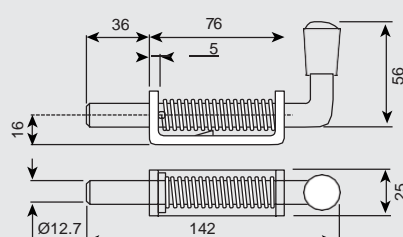

0838/001

TWIST LEVER OPERATION.
ZINC PLATED BALL WITH A SELF
COLOUR BRACKET
SELF COLOUR STEEL BODY WITH
A ZINC PLATED LEVER

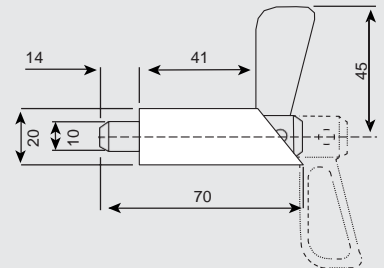

All measurements in mm

Bakjam Steel Fabrications

T+971 4 3400 901 E: info@bakjam.com W: www.bakjamfabrications.com

Al Quoz industrial area # 4, Dubai, UAE